

**CERTIFIED RECORD OF LAND CORNER MONUMENTATION**

**History of original corner establishment:**

Corner established in 1884 by William Barr, Under General Land Office Contract No. 492. Surveyor Generals Notes State:  
 Set basalt stone 22x12x6" 16" in the ground, for corner to sections 27,28,33, and 34, marked with 3 notches on E and 1 notch on S edges  
 From which:  
 A Tamarack 24" dia. bears N70°E, 23 lks dist. marked T7S R35½E S27 BT.  
 A Tamarack 24" dia. bears S70°E, 13 lks dist marked T7S R35½E S34 BT.  
 A Tamarack 12" dia. bears S40°W, 39 lks dist. marked T7S R35½E S33 BT.  
 A Tamarack 6" dia. bears N30°W, 37 lks dist. marked T7S R35½E S28 BT.

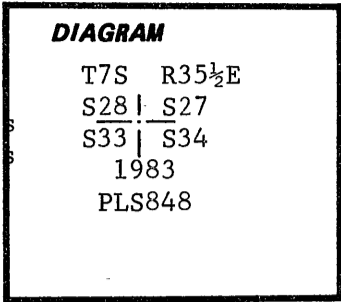

**Description of corner evidence found:**

Found a 20"x12"x6" stone with 3 grooves on one face, stone is lying loose on steep slope. Located position of corner from the original bearing trees as follows:  
 A Dead Tamarack 8" dia. with scribing visible bears N30°W, 23.7 ft.  
 A " " 16" " " " " " " N70°E, 13.8 ft.  
 A " " 22" " " " " " " S60°E, 8.5 ft.  
 A " " 14" " blaze healed ovej, bears S40°W, 25.2 ft.

**Description of monument and accessories | established to perpetuate the original location of this corner:**

Set a 30"x2½" aluminum pipe with a 2½" aluminum cap stamped as shown in diagram. Set 22" in the ground and set original stone South alongside pipe.  
 From which:  
 A Spruce 6" dia. bears N48°W, 27.8 ft. scribed S28 BT:  
 A " 5" " " " N8°E, 19.8 ft. S27 BT:  
 A " 5" " " " S27°E, 11.2 ft. " S34 BT.  
 A " 4" " " " S55°W, 19.5 ft. " X BT.  
 Full scribing would kill these small trees.  
 Set steel post with warning sign 2 ft. North.  
 Nailed brass washers stamped PLS848, bearing tree and warning signs to each tree.  
 Painted 6" red band around each tree.

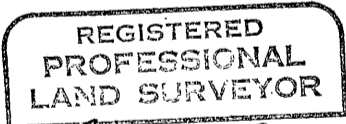

Corner monumented 8-22-83  
 Witnessed by D. Mitchell Ferguson

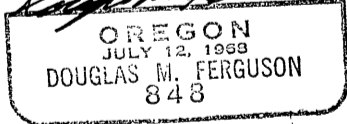

Office of Surveyor County of Grant  
 State of Oregon, I hereby certify that the within instrument was filed in this office  
 for record on the 22 day of Nov, 1983  
Robert D. Baggett by \_\_\_\_\_  
 (COUNTY OFFICIAL) (DEPUTY)